

H44^H_W-150Lb

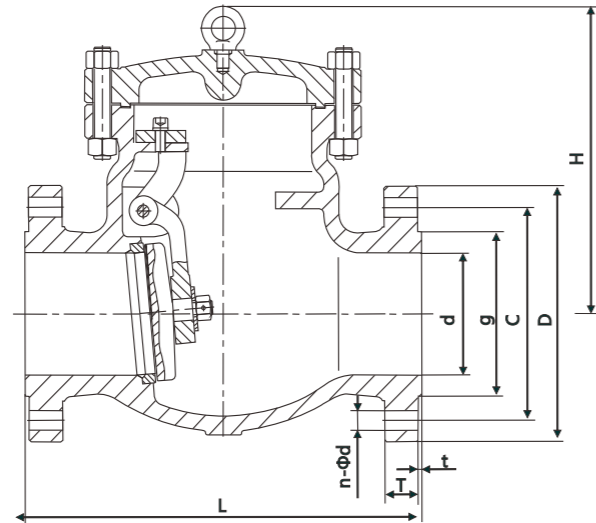

Main dimensions

Nominal pressure	size									
	in	d	L	D	C	g	T	t	H	n-Φ
Class 150Lb	1/2"	15	108	89	60.5	35	12	1.6	-	4-15
	3/4"	20	117	98	70.0	43	12	1.6	-	4-15
	1"	25	127	108	79.5	51	12	1.6	-	4-15
	1-1/4"	32	140	117	89	64	13	1.6	-	4-15
	1-1/2"	40	165	127	98.5	73	15	1.6	-	4-15
	2"	50	203	152	120.5	92	16	1.6	161	4-19
	2-1/2"	65	216	178	139.5	105	18	1.6	180	4-19
	3"	80	241	190	152.5	127	19	1.6	190	4-19
	4"	100	292	229	190.5	157	24	1.6	203	8-19
	5"	125	330	254	216	186	24	1.6	229	8-22
	6"	150	356	279	241.5	216	26	1.6	257	8-22
	8"	200	495	343	298.5	270	29	1.6	292	8-22
	10"	250	622	406	362	324	31	1.6	355	12-25
	12"	300	698	483	432	381	32	1.6	396	12-25
	14"	350	787	533	476	413	35	1.6	445	12-29
	16"	400	864	597	540	470	37	1.6	490	16-29
	18"	450	978	635	578	533	40	1.6	520	16-32
	20"	500	978	698	635	584	43	1.6	546	20-32
	24"	600	1295	813	749.5	692	49	1.6	880	20-35
	26"	650	1295	786	744.5	711	41	1.6	910	36-22
28"	700	1448	837	795.5	762	44	1.6	935	40-22	
30"	750	1524	887	846.0	813	44	1.6	970	44-22	

Main dimensions

Nominal pressure	size									
	in	d	L	D	C	g	T	t	H	n-Φ
Class 300Lb	1/2"	15	152	95	66.5	35	15	1.6	-	4-15
	3/4"	20	178	117	82.5	43	16	1.6	-	4-19
	1"	25	203	124	89	51	18	1.6	-	4-19
	1-1/4"	32	216	133	98.5	63	19	1.6	-	4-19
	1-1/2"	40	229	156	114.5	73	21	1.6	-	4-22
	2"	50	267	165	127	92	22	1.6	178	8-19
	2-1/2"	65	292	190	149	105	25	1.6	190	8-22
	3"	80	318	210	168	127	29	1.6	216	8-22
	4"	100	356	254	200	157	32	1.6	241	8-22
	5"	125	400	279	235	186	35	1.6	267	8-22
	6"	150	444	318	270	216	37	1.6	305	12-22
	8"	200	533	381	330	270	41	1.6	368	12-25
	10"	250	622	444	387.5	324	48	1.6	394	16-29
	12"	300	711	521	451	381	51	1.6	445	16-32
14"	350	838	584	514.5	413	54	1.6	470	20-32	
16"	400	864	648	571.5	470	57	1.6	533	20-35	
18"	450	978	711	628.5	533	60	1.6	584	24-35	
20"	500	1016	775	686	584	64	1.6	610	24-35	
24"	600	1346	914	813	692	70	1.6	900	24-41	
Class 600Lb	2"	50	292	165	127	92	33	6.4	203	8-19
	2-1/2"	65	330	190	149	105	36	6.4	229	8-22
	3"	80	356	210	168	127	39	6.4	235	8-22
	4"	100	432	273	216	157	45	6.4	286	8-25
	5"	125	508	330	266.5	186	52	6.4	292	8-29
	6"	150	559	356	292	216	55	6.4	330	12-29
	8"	200	660	419	349	270	63	6.4	381	12-32
	10"	250	787	508	432	324	71	6.4	457	16-35
	12"	300	838	559	489	381	74	6.4	584	20-35
	14"	350	889	603	527	413	77	6.4	635	20-38
	16"	400	991	686	603	470	84	6.4	684	20-41
	18"	450	1092	743	654	533	90	6.4	752	20-44
	20"	500	1194	813	724	584	96	6.4	975	24-44

An overview of the

The American standard check valve produced by our company is designed and manufactured in accordance with American standard with beautiful structure. Advanced. American standard check valve is to rely on the medium itself flow and automatically open and close the disc, to prevent medium backflow valve, also known as check valve, check valve, countercurrent valve. Check valve belongs to an automatic valve, its main role is to prevent media flow back, prevent pump and drive motor reverse, and the discharge of container media.

The performance parameters

The serial number	The project name	The project name					
		150(Lb)	300(Lb)	600(Lb)	900(Lb)	1500(Lb)	2500(Lb)
1	Nominal pressure	2.0	5.0	10.0	15.0	25.0	42.0
2	Shell strength test pressure	1.5 times nominal pressure at normal temperature					
3	High pressure seal test pressure	1.1 times of working pressure at normal temperature					
4	Working pressure at normal temperature	Rated according to ASME B1634 pressure and temperature					

The product specification

Design criteria	The length of the structure	Flange connection dimensions	Test and inspection	Pressure and temperature reference
BS1868/API6D ASME B16.34	ASME B16.10	ASME B16.5 ASME B16.47 series A	API 598/API 6D	ASME B16.34

Main parts and materials

Part name	The name of the material					
The valve body	A216 WCB	A217 WC6	A351 CF8	A351 CF8M	A351 CF3	A351 CF3M
The cover	A216 WCB	A217 WC6	A351 CF8	A351 CF8M	A351 CF3	A351 CF3M
Valve plate	A216 WCB	A217 WC6	A351 CF8	A351 CF8M	A351 CF3	A351 CF3M
Sealing surface	13Cr/STL	STL	本体/STL	本体/STL	本体/STL	本体/STL
Valve shaft	A182 F6a	A182 F11	A182 F304	A182 F316	A182 F304L	A182 F316L
gasket	304+ flexible graphite/soft iron	304+ flexible graphite /F304	304+ flexible graphite /F304	316+ flexible graphite /F316	304L+ flexible graphite /F304L	316L+ flexible graphite /F316L
bolt	A193 B7	A193 B16	A193 B8	A193 B8M	A193 B8	A193 B8M
nut	A194 2H	A194 4	A194 8	A194 8M	A194 8	A194 8M
The use of temperature	-29~425°C	-29~540°C	-46~425°C	-46~425°C	-46~425°C	-46~425°C
Applicable medium	Water, steam, oil, etc	Water, steam, etc	Nitric acid corrosion medium	Nitric acid corrosion medium	Nitric acid corrosion medium	Nitric acid corrosion medium